

LCD-Color-Display, MicroVis C2

The LCD Display MicroVis C2 is used for operating, displaying, monitoring and reporting in EIB/KNX systems. It serves for visualisation and operation from a central spot of the building.

The design of the user-interface will be configured with the graphical software-tool ArcSuite. Menu navigation and page views can be freely arranged. Compiled projects are transferred by a standard USB connector to the device.

A rotary control button leads through the menu and allows not only to switch and dim but also to set up analogue values as e.g. temperature, brightness or volume. The two additional, freely programmable, push buttons can be used to support, within the menu navigation, direct switching, or to recall complete scenes.

Optional are integrated a temperature- and moisture-sensor (article 22211100).

Areas of application

- Switching and Dimming of the lighting
- Display of the switching status in the house
- Switch-on, and -off of various devices
- Manipulation of jalousies
- Alarm functions, acoustical and optical, with text indicator
- Alarm display of motion detectors with text indicator
- Display and setting up of the heating control
- Title selection and volume adjustment in Multiroom-plants
- Display of outdoor and indoor temperature, time and date.
- Realisation of logic operations in KNX-Bus

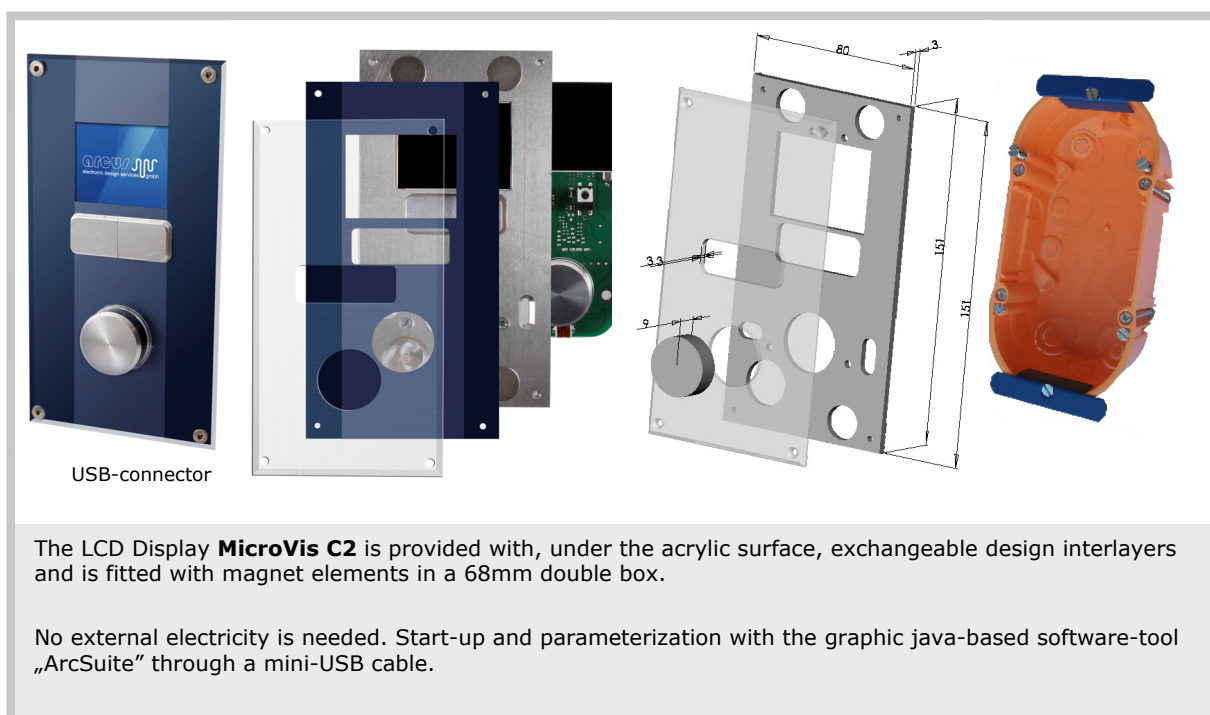

Software ArcSuite

- Java based PC-Software
- Disposable, Download www.arcus-eds.de
- LCD Display MicroVis II logic+ is programmable via USB-port

Hardware:

- 50 MHz ARM7-Processor (256kByte internal memory) for quick 32-Bit integer operations and 64-Bit floating point calculations
- 128 kByte memory size for use e.g. 24 JPG-pictures for one project
- Piezo-signaler for alarm messages
- Rotary control button with detent for input and navigation + 2 additional freely programmable buttons

Graphic and Software:

- LCD-Color Display: 160x128 Pixel, BxH 37 x 30mm, 48mm
- Free design of page contents
- 32 elements can be defined free in size and position
- The number of pages is limited only by the internal memory space (128kByte),
- Different character fonts, font sizes, editable fonts
- Attachment of jpg-graphics as background picture, for representation or as control element
- Freely programmable surfaces and text elements
- Assignment of pictures as value elements, assignment of text as value elements
- Switch-key/push button, turning dimmer, value display, list display of values and text, horizontal and vertical value bars
- Value bars adjustable turning the rotary control button (number and size of steps adjustable)
- Programmable user functions (diagram), clock timer, Pin-code, scene-generator
- Extensive operating element (jalousie switch key)
- Optional integrated temperature and humidity recording
- Setting of system-values on the display (brightness, contrast, system-date, system-time, standby-time)
- Pages directly callable by the button (compilation of the menu), hiding of pages
- Display of HVAC-Icons
- Display of an actual page by alarm call
- Additional programming language Forth with extensive mathematic and logical components to generate independent elements

KNX-elements:

- Up to 128 group addresses through polling with start
- 17 EIS-types incl. 14byte ASCII-character string
- Listening group addresses
- Filtered acceptance of group addresses from the ETS
- Direct dimming function with rotary control button, dimming through stop telegram
- Buttons (1bit) as switch or key elements with stop telegram
- System time/system date
- Brightness, contrast and background lighting adjustable by KNX-object
- All EIS-types callable as acoustical or optical alarm function
- Acoustic alarm freely programmable

Affixing and Installation:

- Connection and supply: directly on the KNX-Bus, DC 24 V, ca. 17mA, no additional auxiliary supply necessary
- No Bus-Coupling necessary
- USB-port to transfer projects
- No Bus-Coupling necessary
- USB-port to transfer projects
- Environment temperature: Storage -5...+60 °C, Operating -5...+55 °C
- Measurements: 150 mm x 80 mm
- Protection: IP 20

Delivery including USB-cable, mounting-angles und up-standard-double-box 68mm

Imprint:

Publisher: Arcus-EDS GmbH, Rigaer Str. 88, 10247 Berlin

Responsible for Content: Hjalmar Hevers, Reinhard Pegelow

Reprints, including partial reprints, can be made only with expressed permission from Arcus-EDS GmbH. This information is the best to our knowledge and is without guarantee. We reserve the right to make any technical and price changes at any time.

Liability:

Selection and determining the appropriateness of the devices for a designated purpose is the customer's full responsibility. We offer no liability or guarantee for this. The data in the catalogue and data sheets is a result of experienced measurements and does not embody a guarantee of particular features. Arcus excludes responsibility for damage done on the part of the customer due to improper operation/projecting or malfunctions. On the contrary, the operator/projector must know that improper operation, and projection and malfunctions do not lead to any further damage.

Safety Guidelines:

Attention! Installing and assembling electrical devices must only be done by an electronics specialist. The customer should be aware of and adhere to the safety guidelines of VDE, TÜV and the appropriate energy provider. Our guarantee does not include defects and damage caused by improper use or non-compliance of operating instructions.

Warranty:

We provide a warranty as required by law. Please contact us in case of malfunction and send the device with a full description of the fault to the address below

Manufacturer:



Registered Trademarks:



The CE Trademark is an unofficial market trademark used exclusively by authorities and provides no warranty of properties.



Registered Trademark of Konnex Association